





Southeast view



Southwest view

Conceptual renderings

The volunteer firefighters, always at the ready, quickly don their gear before heading to a house that is already engulfed in flames. They can almost smell the smoke as they go through their practiced and precise motions.

## Time is of the essence.

Anticipation spikes as their truck makes a slow exit. It's too big for its stall. Firefighters have to wait for a building door to open before getting into the truck. It's a continuous reminder that the community's emergency services facility is far out of date in relation to necessary modern equipment and training needs.

**Our force needs reinforcements.  
You can help.**

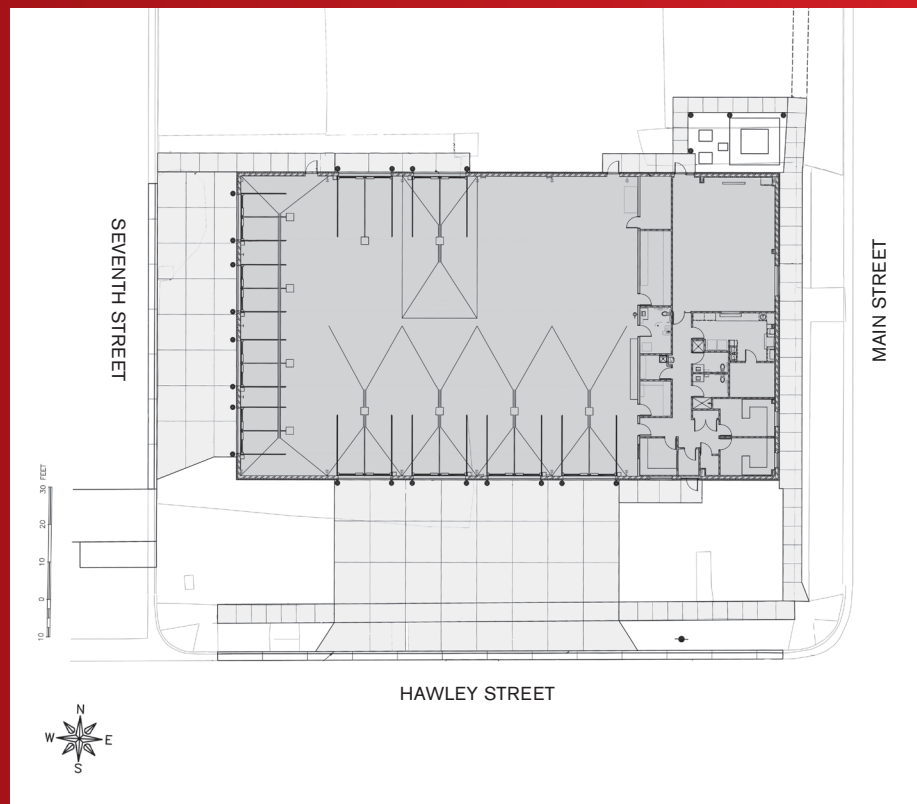



## Jesup's Emergency Services: Reinforcing Our Force

The time has come to construct a new, more functional emergency services building to serve Jesup and the surrounding area. The new facility will provide a more effective and efficient home for Jesup's Fire and Ambulance departments – when every second matters.

A new, 11,890-square-foot emergency services facility is planned to house both departments in one building, which will be located north of Hawley Street, between Seventh Street and Main Street.

### **A new emergency services building will benefit the community by providing:**

- ▶ **Equipment bays large enough to accommodate modern, more complicated trucks**
- ▶ **A place where both emergency departments can be housed, allowing them to better work together**
- ▶ **Additional rooms to accommodate meetings and training**
- ▶ **A functional building which can help recruit future volunteer firefighters and ambulance department members**
- ▶ **More secure storage for emergency supplies and equipment**



## **Keep the Power On**

The new building will be equipped with a 150 kW natural gas generator with an automatic transfer switch that will provide emergency power to both the emergency services facility and one of the city's municipal water wells. Having emergency power for the emergency services facility will allow emergency responders to perform their duties during a power outage, as well as provide a location where members of the community can gather to obtain electricity for critical medical equipment or other urgent needs. Having emergency power to the city's municipal water well will enable the city to continue to provide a safe, reliable source of drinking water during extended power outages and maintain a reserve of water that may be needed in the event of a fire in the area.



## Fire Services

**35**  
firefighters 

**120**  
square-mile area 

**120-140**  
calls annually 

**6,000**  
residents within  
covered area 

## Ambulance Services

**19**  
volunteers 

**140**  
square-mile area 

**200**  
calls annually 

**2**  
LifeLine<sup>®</sup>  
ambulances 

## Jesup Emergency Services – After the Campaign

City leaders have recognized the efficiency of combining fire and ambulance operations into one building. There are some firefighters who work dual roles as EMTs. Several firefighters also drive for the ambulance department. A building housing both departments would provide:

- ▶ Enhanced communication between the two departments
- ▶ Optimized space and opportunities for cross training between the fire and ambulance departments
- ▶ Increased volunteer interaction between members of the fire department and the ambulance department





*"If we didn't have the ambulance service in Jesup, who knows what would have happened to me. I don't think I would have survived due to the circumstances I was under. I lost a lot of blood. If it wasn't for them being able to stabilize me, I probably would be underground."*

—Chris Salinas, Jesup resident and accident survivor

## Jesup Emergency Services Impact

During a heavy February snowstorm, Jesup resident Chris Salinas found himself in one of the situations Midwesterners most fear. Headed to work through the storm, and with roads becoming increasingly dangerous, he decided it was too risky and turned around to go back home. While driving on Dubuque Road, a semi-truck passed, creating a white-out condition. When it cleared, Salinas was face-to-face with a pickup truck that had crossed over into his lane. There was no time to react.

The crash happened just west of Jesup. Crews from Jesup Fire and Ambulance were at the scene quickly and removed the roof of the car to rescue Salinas, who was taken to the hospital with life-threatening injuries.

In January 2015, Melissa Kite, her husband and their daughter were sleeping when they awoke to firefighters pounding on their door. The home next door was on fire, and they had to exit their home as quickly as possible. At first, Melissa couldn't see the fire.



*"All of a sudden, they just knew exactly where to go, ripped open the end of the trailer and there was the fire. They were so fast putting it out; it never spread. It could have been a lot worse. It was cold and it was very windy that day, but they just kept it under control. I was very impressed."*

*"They go to work at their normal jobs, and in the middle of the night, if something happens, that's who you call, and they're willing to help."*

—Melissa Kite, Jesup resident







## How You Can Help Reinforce the Force

The city has saved roughly \$1 million in project costs for the new Emergency Services facility over the past two years by restructuring the building plans. In order to move ahead without further delays, the project funding had to be set in place. The council did that by tying up projected future local option sales tax funds for the next 20 years.

In order to free up as much of this funding as possible for future projects, donations are now being accepted for the new Emergency Services facility. With a \$750,000 private fundraising goal, not only will future sales tax funds be freed up as the bonds are paid off in advance, but the city will also save money on interest. Your tax-deductible gift toward this project now will help the entire fire/ambulance district save money for upcoming projects. At what level are you able to participate?

Pledges are encouraged and may be extended over a period of up to three years. Naming opportunities are available if interested.



### Steering Committee

Kay Alferink, Co-chair  
John Molacek, Co-chair

Kim Adams  
Harold Allen  
Brett Bloes  
Mark Collett  
Fritz Kies  
James Masteller  
Marsha McGlaughlin  
Tom McGlaughlin  
Nyle McMartin  
Richard Mott  
Sue Neverman  
Todd Rohlfen  
Rick Rottinghaus  
Cassie Shaffer  
Larry Thompson  
Brian Van Brocklin  
Dawn Vogel  
Joel Waskow  
Tom Youngblut







***"The response time is critical in every emergency situation, whether it be ambulance calls or fire department. And you have to have good equipment for a good response. Today, the equipment is bigger, more complicated and more expensive; and it kind of looks like, to me, the building has shrunk when you walk around in it."***

**-Nyle McMartin**, Chairman of the Fire Advisory Board, Jesup



City of Jesup  
791 6th Street  
P.O. Box 592  
Jesup, IA 50648  
319-827-1522  
[www.JesupESFBuilding.net](http://www.JesupESFBuilding.net)